

X type

Features and Strengths

Excellent in handling very thin and flexible plastic bags
 Various stopper & lip material options to cover a wide range of vacuum application



Examples of use

Very thin plastic bags, Pouch bags

Recommended Lifting Force (Max.)

Model	Volume (cm ³)	Lifting Force (Kg) – Perpendicular		
		- 20 kPa	- 60 kPa	- 90 kPa
B1.5/20-XB12	2.2	0.14	0.31	0.42
B1.5/20-XB15	2.5	0.20	0.42	0.48
B1.5/20-XB17	2.6	0.27	0.44	0.54
B1.5/20-XB20	3.2	0.31	0.56	0.68
B1.5/20-X25	2.93	0.80	1.79	2.44
B1.5/20-X30	4.53	1.08	2.13	2.62
B1.5/40-X40	14.9	1.80	4.60	7.40
B1.5/40-X45	17.8	2.14	3.57	5.00
B1.5/40-X50	23.2	2.30	5.50	8.30
B1.5/40-X55	23.05	2.60	5.27	5.92
B1.5/60-X65	43	4.80	11.50	15.90
B1.5/60-X75	62.5	5.60	12.30	17.90
B2.5/20-XB12	3.9	0.14	0.31	0.42
B2.5/20-XB15	4.2	0.20	0.42	0.48
B2.5/20-XB17	4.4	0.27	0.44	0.54
B2.5/20-XB20	4.9	0.31	0.56	0.68
B2.5/20-X25	5.04	0.80	1.79	2.44
B2.5/20-X30	6.64	1.08	2.13	2.62
B2.5/40-X40	19.4	1.80	4.60	7.40
B2.5/40-X45	25.2	2.14	3.57	5.00
B2.5/40-X50	27.6	2.30	5.50	8.30
B2.5/40-X55	32.4	2.60	5.27	5.92
B2.5/60-X65	63.8	4.80	11.50	15.90
B2.5/60-X75	83.3	5.60	12.30	17.90
B4.0/20-XB12	3.9	0.14	0.31	0.42
B4.0/20-XB15	4.3	0.20	0.42	0.48
B4.0/20-XB17	4.4	0.27	0.44	0.54
B4.0/20-XB20	4.9	0.31	0.56	0.68
B4.0/20-X25	4.77	0.80	1.79	2.44
B4.0/20-X30	6.37	1.08	2.13	2.62
B4.0/40-X40	27.7	1.80	4.60	7.40
B4.0/40-X45	31	2.14	3.57	5.00



Recommended Lifting Force (Max.)

Model	Volume (cm ³)	Lifting Force (Kg) – Perpendicular		
		- 20 kPa	- 60 kPa	- 90 kPa
B4.0/40-X50	35.9	2.30	5.50	8.30
B4.0/40-X55	38.2	2.60	5.27	5.92
B5.0/20-XB12	5.1	0.14	0.31	0.42
B5.0/20-XB15	5.4	0.20	0.42	0.48
B5.0/20-XB17	5.6	0.27	0.44	0.54
B5.0/20-XB20	6.1	0.31	0.56	0.68
B5.0/20-X25	5.93	0.80	1.79	2.44
B5.0/20-X30	7.53	1.08	2.13	2.62
B5.0/40-X40	34.5	1.80	4.60	7.40
B5.0/40-X45	37.8	2.14	3.57	5.00
B5.0/40-X50	42.7	2.30	5.50	8.30
B5.0/40-X55	45.0	2.60	5.27	5.92
B5.0/60-X65	104.8	4.80	11.50	15.90
B5.0/60-X75	124.3	5.60	12.30	17.90
B6.0/20-XB12	6.9	0.14	0.31	0.42
B6.0/20-XB15	7.2	0.20	0.42	0.48
B6.0/20-XB17	7.3	0.27	0.44	0.54
B6.0/20-XB20	7.9	0.31	0.56	0.68
B6.0/20-X25	8.02	0.80	1.79	2.44
B6.0/20-X30	9.62	1.08	2.13	2.62
B6.0/40-X40	39.0	1.80	4.60	7.40
B6.0/40-X45	45.1	2.14	3.57	5.00
B6.0/40-X50	47.2	2.30	5.50	8.30
B6.0/40-X55	52.3	2.60	5.27	5.92
B6.0/60-X65	126.6	4.80	11.50	15.90
B6.0/60-X75	146.1	5.60	12.30	17.90



Material Specifications

Material	Hardness Shore (°)	Color	Temperature (°C)
NBR (Nitrile)	60	Black	-20~110
S3 - Silicone	30	Translucent White	-70~200
S5 - Silicone	50	Red	-70~200
WS3 - White Silicone	30	Translucent White	-70~200
WS5 - White Silicone	50	Translucent White	-70~200
Urethane	60	Dark Grey	0~100

Material Resistance

Description	NBR (Nitrile)	Silicone	White Silicone	Urethane
Wear Resistance	Excellent	Good	Good	Excellent
Oil	Excellent	Poor	Poor	Excellent
Weather / Ozone	Fair	Excellent	Excellent	Excellent
Alcohol	Good	Good	Good	Fair
Acid	Fair	Poor	Poor	Poor



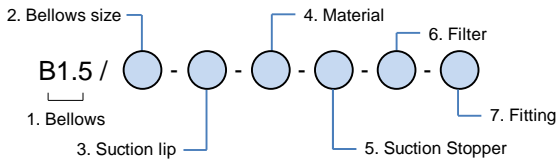

Build an Ordering No.



1. Bellow size	Description	Ordering No.
	Top bellows 1.5 folds	B1.5
	Top bellows 2.5 folds	B2.5
	Top bellows 1.5 folds + Middle bellows 2.5 folds	B4.0
	Top bellows 1.5 folds + Middle bellows 3.5 folds	B5.0
	Top bellows 2.5 folds + Middle bellows 3.5 folds	B6.0
2. Bellows size	Description	Ordering No.
	20mm bellows diameter: For XB12 & XB15 & XB17 & XB20 & X25 & X30	20
	40mm bellows diameter: For X40 & X45 & X50 & X55	40
	60mm bellows diameter: For X65 & X75	60
3. Scution lip	Description	Ordering No.
	XB type lip, 12mm diameter	XB12
	XB type lip, 15mm diameter	XB15
	XB type lip, 17mm diameter	XB17
	XB type lip, 20mm diameter	XB20
	X type lip, 25mm diameter	X25
	X type lip, 30mm diameter	X30
	X type lip, 40mm diameter	X40
	X type lip, 45mm diameter	X45
	X type lip, 50mm diameter	X50
	X type lip, 55mm diameter	X55
	X type lip, 65mm diameter	X65
X type lip, 75mm diameter	X75	
4. Material	Description	Ordering No.
	NBR (Nitrile), 60° hardness	N6
	Silicone, 30° hardness	S3
	Silicone, 50° hardness	S5
	White Silicone, 30° hardness	W3
	White Silicone, 50° hardness	W5
	White Silicone, 30° hardness (FDA)	W3(FDA)
	White Silicone, 50° hardness (FDA)	W5(FDA)
	Urethane, 60° hardness	U



5. Suction Stopper	Description	Ordering No.
	A type	A
	B type	B
	C type	C
	D type	D
6. Filter	Description	Ordering No.
	No filter	Blank
	Filter (200mesh)	F2
7. Fitting	Description	Ordering No.
	Fitting, G1/8 female	18F
	Fitting, G1/4 female	14F
	Fitting, G1/8 male	18M
	Fitting, G1/4 male	14M
	Fitting, G3/8 male	38M
	Fitting, G3/8 female: Only for 60mm bellow diameter	38F



Dimension Data

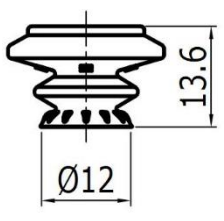

XB12

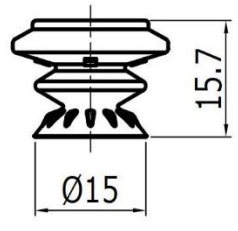

XB15

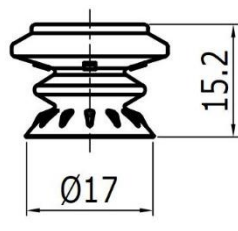

XB17

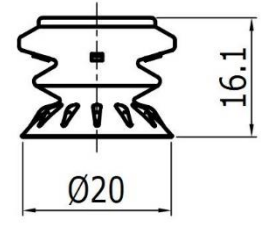

XB20

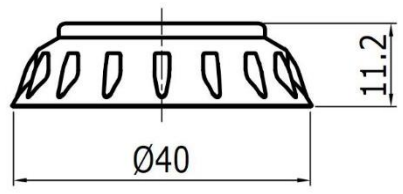

X40

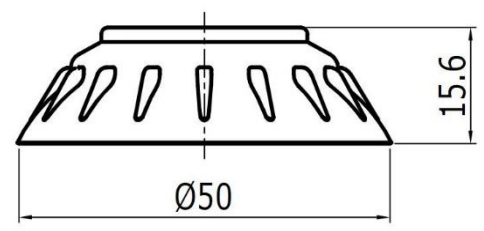

X50